

TL53 SERIES TACT SWITCH

ANTI-VANDAL SWITCHES
 DETECTOR SWITCHES
 DIP SWITCHES
 KEYLOCK SWITCHES
 NAVIGATION SWITCHES
 PUSHBUTTON SWITCHES
 ROCKER SWITCHES
 ROTARY SWITCHES
 SLIDE SWITCHES
 SNAP ACTION SWITCHES
TACTILE SWITCHES
 TOGGLE SWITCHES
 CAP OPTIONS

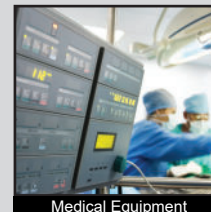

APPLICATIONS / MARKETS

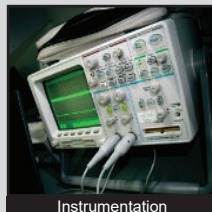
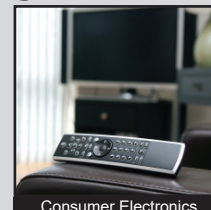
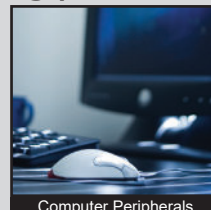
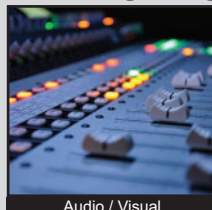

RoHS

SPECIFICATIONS

Contact Rating: 12VDC 50mA
Life Expectancy: 100,000 cycles
Contact Resistance: 100mΩ max., typical @ 2-4 VDC 100mA
Insulation Resistance: 100mΩ min
Dielectric Strength: 250VAC
Operating Temperature: -20°C to 70°C
Travel: 0.25mm
Operating Force: F100 - 100 ±50gf, F160 - 160 ±50gf, F260 - 260 ±50gf
Function: SPST, Off-(On)

FEATURES & BENEFITS

- Two independent switches in a single package
- Stacked design
- Reliable dome contact technology

PART NUMBER CONFIGURATOR

Series

TL

Model

53

Actuator

(None) - 3.15mm
 A - 3.85mm
 B - 5.85mm
 C - 6.15mm
 D - 6.85mm
 E - 7.35mm
 G - 8.35mm
 H - 11.85mm

Operating Force

F100 - 100 gf
 F160 - 160 gf
 F260 - 260 gf

Contact Material

Q - Silver

Specifications subject to change without notice 4.30.2024



E-SWITCH®

www.e-switch.com

800.867.2717

1

TL53 SERIES TACT SWITCH

BODY DIMENSIONS

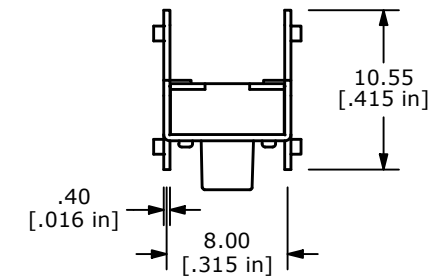
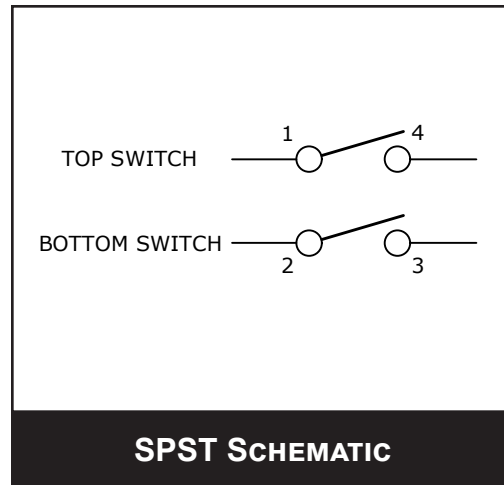
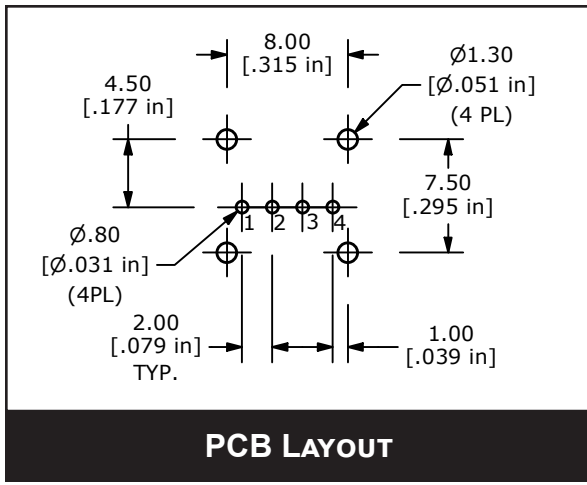

| ACTUATOR | "X" |
|----------|---------|
| A | 3.85mm |
| B | 5.85mm |
| C | 6.15mm |
| D | 6.85mm |
| E | 7.35mm |
| G | 8.35mm |
| H | 11.85mm |

